

**VIRGINIA MINING INSTITUTE
DAY 1 COMPETITION
CHAIRMAN'S INSTRUCTIONS**

- Have all the judges at the field prior to the team arriving.
- Check the field for mistakes and placard placement prior to the team arriving on the field.
- Keep up with the stopwatch.
- Assign a judge to be the official timekeeper.
- Ensure that all placards are turned at the proper time.
- Collect both maps from the teams after the clock is stopped.
- Compare the time clock with the official timekeeper and ensure the correct time is recorded on the time card.
- Confirm the final location of all ventilation controls with the team captain and record on a blank map.
- Ensure that all judges, including the Superintendent, fill out the scorecards after the completion of the problem.

**VIRGINIA MINING INSTITUTE
DAY 1 COMPETITION
SUPERINTENDENTS INSTRUCTIONS**

- Assist the field manager and chairman in checking the field for mistakes and placard placement prior to the team starting the problem.
- Read the prepared statement when the team is ready but do not answer questions regarding the problem or conditions in the mine.
- The team has a maximum of five (5) minutes to review the statement after it is read.
- When the team is ready to start the problem present the team instructions, maps and a copy of the written statement to the team captain.
- After giving the team instructions and maps to the team, report to the command center and be ready to respond to any communications from the briefing officer.
- Record the names of all missing persons found and all mixes encountered by the team. (These must be reported prior to the team leaving the location found.)
- Help the chairman with the collection of the mine maps and mapping of the final ventilation.
- Assist judges in filling out the scorecards upon conclusion of the problem.

VIRGINIA MINING INSTITUTE
DAY 1 COMPETITION 2008
WRITTEN STATEMENT

I am _____, Superintendent of Hard Times Coal Company's No. 1 mine. We are standing in the fresh air base, which is located at Survey Station No. 24106 on the 1 West Mains development section.

We have had a problem and appreciate you answering our call for help.

At approximately 11PM last night a 4 man maintenance crew went to the 001-0 MMU to perform scheduled maintenance on the equipment. At 6:30AM this morning a member of a 3 man maintenance crew that was working on a beltdrive located at the mouth of the section called out and reported hearing a loud roof fall or possibly an explosion followed by dust or smoke coming from the direction of the 001-0 MMU. The heavy dust or smoke made it impossible for the men to travel the section to check on the other maintenance crew. This 3 man crew is now on the surface. A company rescue team advanced to this location and started encountering permanent ventilation controls that had been destroyed; a fresh air base was then established.

Another mine rescue team is here to serve as back-up.

All necessary MSHA and State officials are on site with representatives located in the command center.

A competent lifeline judge is on hand. (point out person)

A command center has been established to send and receive information to and from the briefing officer.

A map and problem will be provided when you are ready.

**VIRGINIA MINING INSTITUTE
DAY 1 COMPETITION
TEAM INSTRUCTIONS**

- Explore all areas that can be safely explored.
- Account for all missing persons and bring all live persons to the Fresh-Air Base.
- Establish communications with the Command Center prior to leaving the Fresh-Air Base.
- Report the following to the Command Center when found and prior to moving from location.
 - 1) Name, location and condition of any missing persons.
 - 2) Any explosive mixtures.
 - 3) Any ignition sources.
- 70 minute TIME LIMIT for working of problem. Team will be notified at 60 minutes/10 minutes left to complete problem.

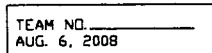

TEAM NO. _____
AUG. 6, 2008

PATIENT'S STATEMENT NO.1 ENTRY LOCATION

**HELP!!! HELP!!!
GET ME OUT OF HERE.
IT'S AIRTIGHT BEHIND ME.**

PATIENT'S STATEMENT
(NO.2 FACE LOCATION)

HELP!!! HELP!!!
GET ME OUT OF HERE.
IT'S AIRTIGHT BEHIND ME.

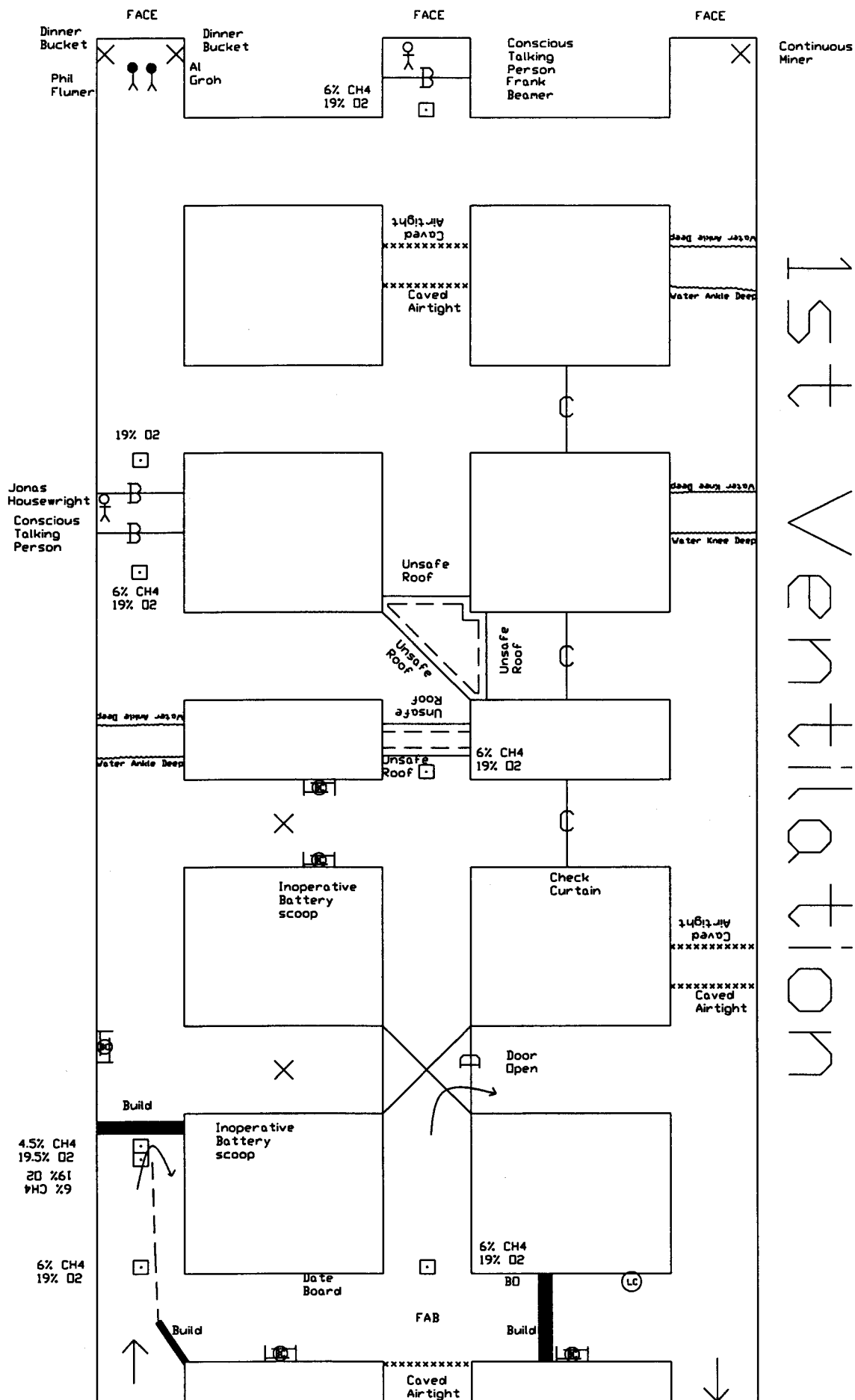

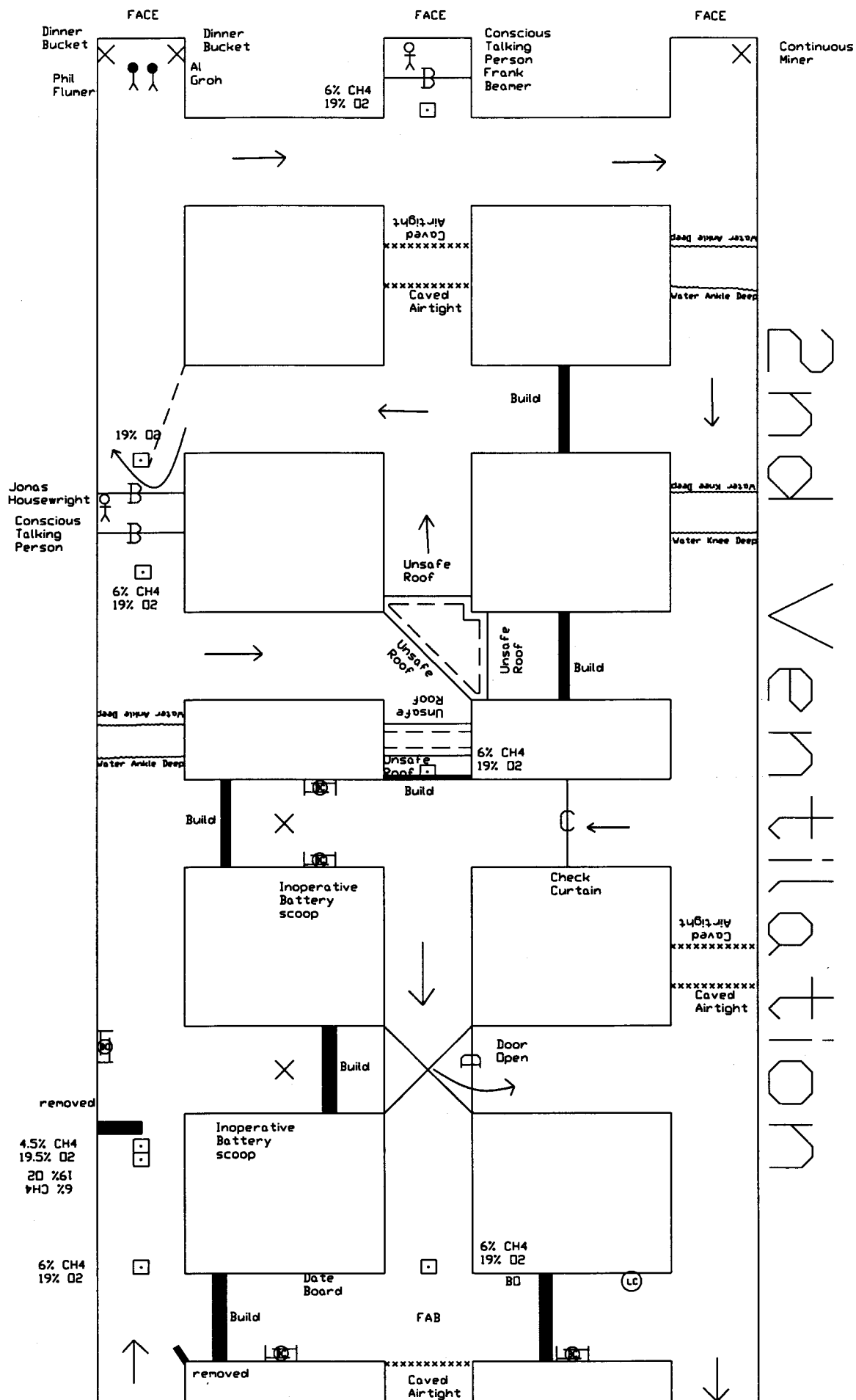

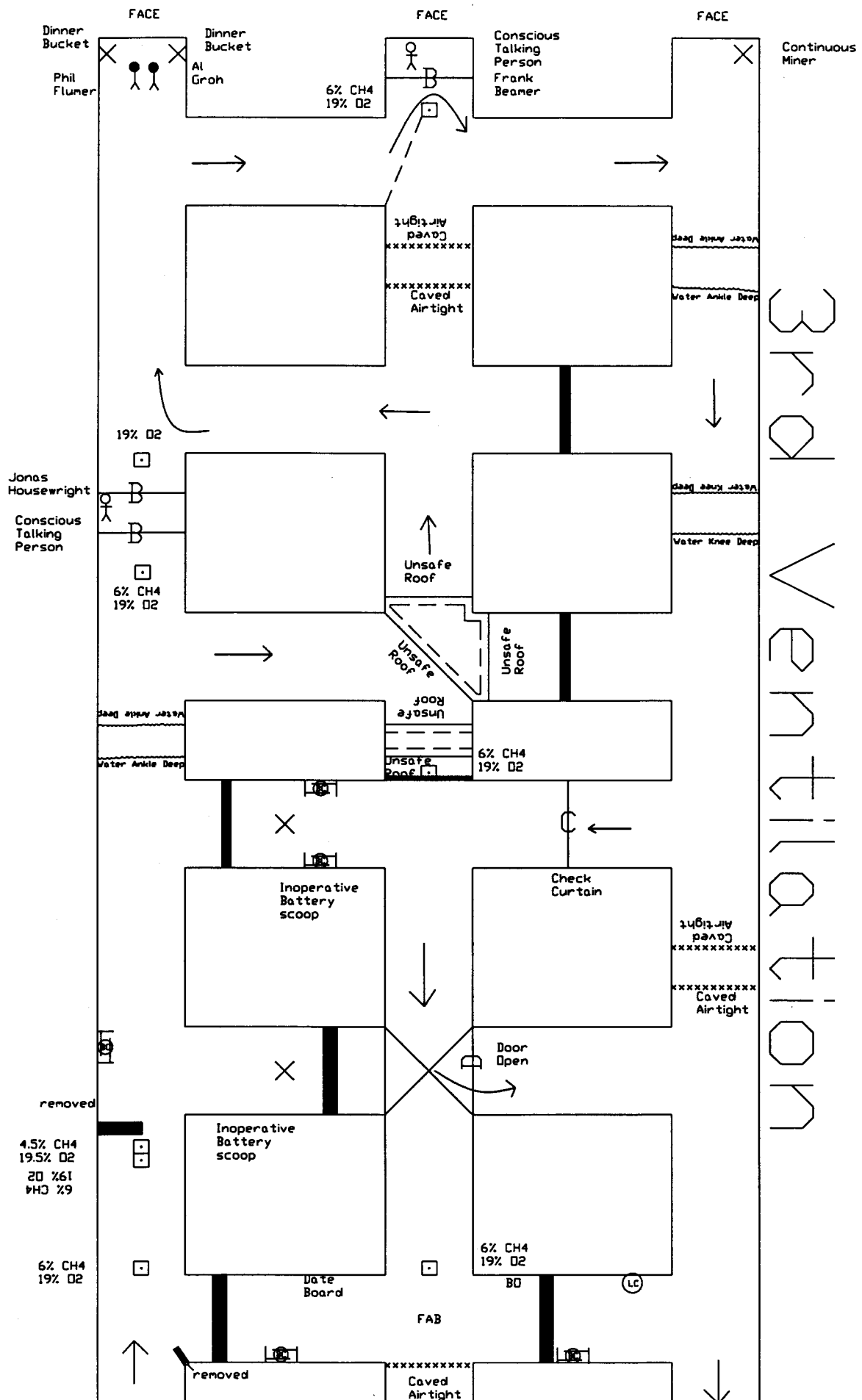

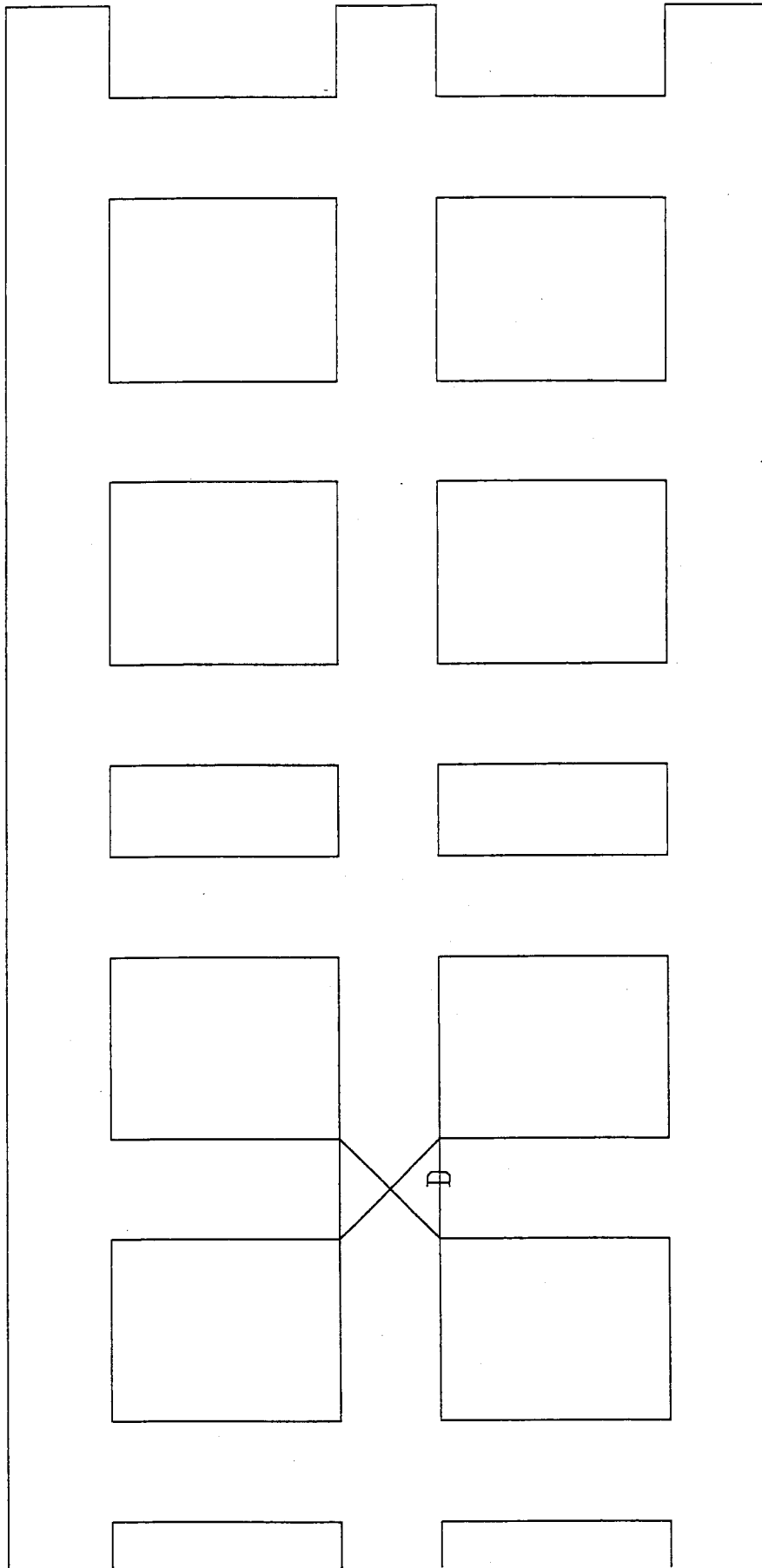

FINAL VENTILATION MAP
TEAM NO. _____
AUG. 6, 2008

Virginia Mining Institute
Day 1 Competition 2008
Ground Rules

1. Nails are not to be used on the field. Top boards have been constructed with slots to connect to the up-rights to stabilize the framework. Ventilation curtains have been provided with Velcro strips. Bottom boards will not be used for temporary stoppings.
2. Connection of permanent stoppings, temporary stoppings, airlocks, or seals will require connection of all straps. Four (4) straps on top and two (2) on each side must be completed. The lower strap on each side may be left loose for check curtains.
3. Frames that are anchored in place on the field cannot be disassembled. An adequate quantity of building material to work the problem will be provided.
4. When removing curtain from the frames, each Velcro strap must be disconnected individually. Do not pull on the curtain to disconnect the Velcro strap. This may result in broken straps.
5. A set of frames and ventilation curtain will be located in the lock-up area so teams can become familiar with erecting ventilation controls before they work the problem.
6. If weather conditions require judges to alter an airtight build (i.e. loosening the straps, sliding the curtain, etc.) on the field during the working of the problem by the team, a four inch (4") yellow strip will be attached by the judges to the cross member to indicate to the team that the build is still intact.
7. 70 minute TIME LIMIT for working of problem. Team will be notified at 60 minutes/10 minutes left to complete problem.